

7929 Lincoln Ave. Riverside, CA 92504
Phone: 951.689.ICON Fax: 951.689.1016

PART #	DESCRIPTION
78500DJ	11-UP GM HD TUBULAR UCA DJ KIT

COMPONENTS INCLUDED	
(1) 174062 11+ GM HD UCA (DRVR)	(1) 172063 11+ GM HD UCA (PASS)
HARDWARE INCLUDED	
(2) 177058BJ DELTA JOINT	(8) 297034 HAT BUSHING 1.625 X 1.000 X .850
(4) 177094 SLEEVE 1.000 X .630 X 2.550	(4) 297043 POLY RING 1.590 X 1.005 X .450
TOOLS REQUIRED	
JACK JACK STANDS 2LB SLEDGE HAMMER BALL JOINT SEPARATOR	TORQUE WRENCH 18MM SOCKET / WRENCH 22MM SOCKET / WRENCH 24MM SOCKET / WRENCH
TECH NOTES	
<p>1. A MAJOR PERFORMANCE ADVANTAGE OF ICON UPPER CONTROL ARMS IS INCREASED CASTER OVER STOCK. DISCUSS WITH A PROFESSIONAL ALIGNMENT SHOP THAT YOU WANT THE VEHICLE ALIGNED WITH THE CASTER AT THE MAXIMUM FACTORY RECOMMENDED SETTINGS TO TAKE ADVANTAGE OF THE DYNAMICS EFFECTS OF INCREASED CASTER.</p> <p>2. IF THE FRONT ALIGNMENT CAMS ARE ADJUSTED ALL THE WAY OUT AND THE ARM HAS TO COME TOWARDS THE TIRE, SLIGHT SANDING MAY BE REQUIRED ON THE DROOP STOP PORTION OF THE CHASSIS TO CLEAR THE UPPER CONTROL ARM GUSSET AT FULL DROOP. DO NOT REMOVE THE DROOP STOP.</p> <p>3. CHECK THE UCA'S WITH THE SUSPENSION FULLY EXTENDED. IF THE WRONG LENGTH SHOCKS ARE USED OR IF THE TORSION BARS ARE OVER PRELOADED, THE UCA'S MAY BIND LEADING TO FAILURE NOT COVERED UNDER ICON'S WARRANTY POLICY.</p> <p>4. IF THE FENDER TO HUB MEASUREMENT AT RIDE HEIGHT EXCEEDS 26.15" (WITHOUT SUBFRAME KIT) THEN THE VEHICLE MAY BE OVER-LIFTED. COMPENET FAILURE CAUSED BY TOO MUCH PRELOAD IN THE TORSION BARS IS NOT COVERED UNDER ICON'S WARRANTY POLICY.</p> <p>5. ICON DELTA JOINTS ARE PRE-GREASED FROM THE FACTORY. ICON RECOMMENDS GREASING THE DELTA JOINT EVERY 3,000 MILES (OR EVERY OIL CHANGE). ADD NEW GREASE UNTIL ALL OF THE OLD GREASE IS EXPELLED FROM THE BOTTOM OF THE DELTA JOINT ASSEMBLY, WIPE AWAY EXCESS WITH A RAG OR SHOP TOWEL.</p> <p>6. ICON RECOMMENDS OPTIONAL BILLET DUST COVER SET (191011) TO PREVENT DEBRIS FROM PACKING UP AROUND THE ZERK FITTING.</p>	



WARNING!
<p>** READ ALL INSTRUCTIONS THOROUGHLY FROM START TO FINISH BEFORE BEGINNING INSTALLATION! IF THESE INSTRUCTIONS ARE NOT PROPERLY FOLLOWED SEVERE FRAME, SUSPENSION AND TIRE DAMAGE MAY RESULT TO THE VEHICLE!</p> <p>** ICON VEHICLE DYNAMICS RECOMMENDS THAT YOU EXERCISE EXTREME CAUTION WHEN WORKING UNDER A VEHICLE THAT IS SUPPORTED WITH JACK STANDS.</p> <p>** ICON VEHICLE DYNAMICS RECOMMENDS ALL INSTALLATION TO BE PERFORMED BY A PROFESSIONAL SHOP/SERVICE TECHNICIAN. PRODUCT FAILURE CAUSED BY IMPROPER INSTALLATION WILL NOT BE COVERED UNDER ICON'S WARRANTY POLICY.</p>

INSTALLATION

- Using a properly rated jack, raise the front of the vehicle and support the frame rails with jack stands. Ensure the jack stands are secure and set properly before lowering the jack. NEVER WORK UNDER AN UNSUPPORTED VEHICLE. Remove the front wheels.
- Using a jack, slightly lift the lower control arm to prevent the suspension from being at full droop.
- Remove the ball joint nut with a 21mm socket/wrench.
- The spindle will need to be supported so that it will not over extend the CV's on 4wd models, or possibly damage steering components. Using a ball joint separator, detach the ball joint from spindle.
- With the upper control arm detached from the spindle, begin to loosen the upper control arm from its mounts in the frame using a 24mm wrench/socket and remove factory upper control arm.
- Before installing your new upper control arms, care must be taken to grease the bushings (liberally) prior to installing assembly. Failure to grease properly will cause premature bushing wear and increased noise. [FIGURE 1]

FIG.1

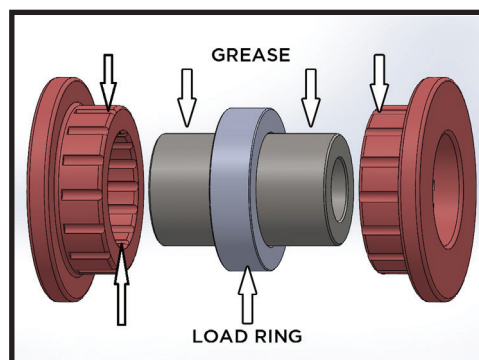

- With the (174062) control arm completely assembled, slide the arm into the upper mounts and insert the OEM hardware loosely.

8. Line up the taper pin with the spindle and insert it without damaging the threads. Use supplied flanged nut to install the taper to the spindle. [Torque to 60 ft-lbs]
9. Before tightening the factory hardware, grease the pivots at the zerk fittings with a grease gun until grease begins to come out of the bushing housing.
10. Tighten the factory upper control arm pivot hardware. [Torque to factory spec]
11. Repeat steps on passenger side.
12. Install wheels and lower vehicle back to the ground. [Torque to factory spec]
13. Have the vehicle professionally aligned. see tech note on alianment.

ITEM NO.	PART NUMBER	DESCRIPTION	QTY
1	174062	11+ GM HD UCA DRVR	1
2	174063	11+ GM HD UCA PASS	1
3	177058	00+ GM HD / 15+ F150 UCA TAPER PIN	2
4	157506	BEARING CAP, .500 I.D.	2
5	605337	1/2-20 X .875 12 PT FLANGED CAP SCREW GR8 BLKZINC	2
6	295550	HCOM 16T STAINLESS STEEL BEARING	2
7	605950	WHT-200 SPIRAL RET RING	2
8	297034	HAT BUSHING 1.625 X 1.000 X .850	8
9	297043	POLY RING 1.590 X 1.005 X .450 (75D) BLK	4
10	605838	M12-1.75 FLANGED NYLOCK NUT GR8.8 CZINC	2
11	605903	1/4-28 X 90 DEG STEEL ZERK FITTING CZINC	4
12	177094	SLEEVE 1.000 X .630 X 2.650 YZINC	4

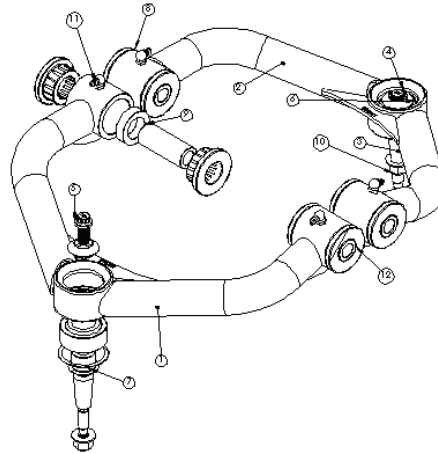

VERIFY ALL FASTENERS ARE PROPERLY TORQUED BEFORE DRIVING VEHICLE.

RETORQUE ALL NUTS, BOLTS AND LUGS AFTER 100 MILES AND PERIODICALLY THEREAFTER.

ICON VEHICLE DYNAMICS LIMITED LIFETIME WARRANTY

ICON Vehicle Dynamics warrants to the original retail purchaser who owns the vehicle on which the product was originally installed. ICON Vehicle Dynamics does not warrant the product for finish, alterations, modifications and/or installation contrary to ICON Vehicle Dynamics instructions. ICON Vehicle Dynamics products are not designed, nor are they intended to be installed on vehicles used in race applications, for racing purposes or for similar activities. (A "race" is defined as any contest between two or more vehicles, or a contest of one or more vehicles against the clock, whether or not such contest is for a prize). This warranty does not include coverage for police or taxi vehicles, race vehicles, or vehicles used for government or commercial purposes. Also excluded from this warranty are sales outside of the United States of America and Canada.

ICON Vehicle Dynamics' obligation under this warranty is limited to the repair or replacement, at ICON Vehicle Dynamics' discretion, of the defective product. Any and all costs of removal, installation or re-installation, freight charges and incidental or consequential damages are expressly excluded from this warranty. Items that are subject to wear are not considered defective when worn and are not covered.

ICON Vehicle Dynamics components must be installed as a complete kit as shown in our current application guide. Any substitutions or exemptions of required components will immediately void the warranty. Some finish damage may happen to parts during shipping and is not covered under warranty.

This warranty is expressly in lieu of all other warranties expressed or implied. This warranty shall not apply to any product that has been improperly installed, modified or customized subject to accident, negligence, abuse or misuse.

ICON VEHICLE DYNAMICS

PERFORMANCE SUSPENSION SYSTEMS AND SHOCK ABSORBERS

7929 Lincoln Ave. Riverside, CA 92504 Phone: 951.689.ICON Fax: 951.689.1016
www.iconvehicledynamics.com



FOLLOW US ON FACEBOOK!

