

PART #	DESCRIPTION
95155	17-UP RAPTOR IMPACT BUMPER KC PRO6 LIGHT BAR MOUNT KIT

COMPONENTS INCLUDED	
(1) 194112 17-UP RAPTOR BUMPER KC PRO6 BRACKET DRV (1) 194113 17-UP RAPTOR BUMPER KC PRO6 BRACKET PASS	(1) 194114 3/8-16 THREADED HEX SPACER
HARDWARE INCLUDED	
(5) 605133 3/8 FLAT WASHER (1) 605155 3/8-16 X 2.50 BOLT	(2) 605839 M10-1.50 X 20MM BUTTON HEAD BOLT
TOOLS REQUIRED	
TORQUE WRENCH 3MM ALLEN 6MM ALLEN	13MM SOCKET / WRENCH 9/16 SOCKET / WRENCH 3/4 SOCKET / WRENCH
TECH NOTES	
1. THESE MOUNTING BRACKETS ARE INTENDED TO MOUNT THE PRO6 BAR IN ITS STRAIGHT CONFIGURATION.	

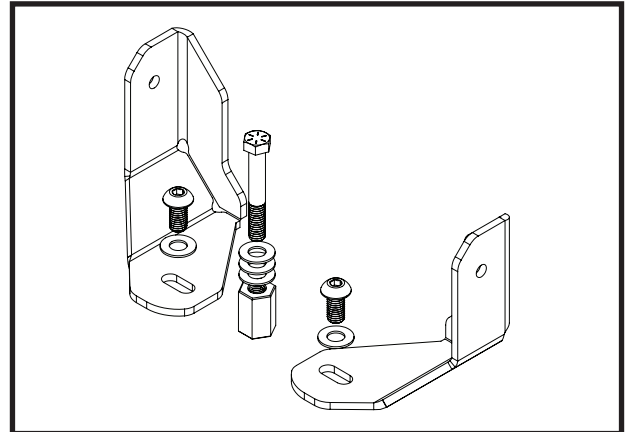

WARNING!
<p><b>** READ ALL INSTRUCTIONS THOROUGHLY FROM START TO FINISH BEFORE BEGINNING INSTALLATION! IF THESE INSTRUCTIONS ARE NOT PROPERLY FOLLOWED SEVERE FRAME, SUSPENSION AND TIRE DAMAGE MAY RESULT TO THE VEHICLE!</b></p> <p><b>** ICON VEHICLE DYNAMICS RECOMMENDS THAT YOU EXERCISE EXTREME CAUTION WHEN WORKING UNDER A VEHICLE THAT IS SUPPORTED WITH JACK STANDS.</b></p> <p><b>** ICON VEHICLE DYNAMICS RECOMMENDS ALL INSTALLATION TO BE PERFORMED BY A PROFESSIONAL SHOP/SERVICE TECHNICIAN. PRODUCT FAILURE CAUSED BY IMPROPER INSTALLATION WILL NOT BE COVERED UNDER ICON'S WARRANTY POLICY.</b></p>

## INSTALLATION

**1.** Mount the brackets to the bumper using the supplied M10-1.50 x 20mm button head screws and a 6mm Allen. Leave them loose for now. [FIGURE 1]

FIG.1



FIG.2



**2.** Mount the KC PRO6 Light Bar to the brackets using hardware supplied with light. Tighten until snug using a 13mm. [FIGURE 2]

**3.** Aim the light bar by tilting it up or down as desired. With the light bar aimed as desired, measure the distance between the top surface of the bumper and the bottom surface of the bolt junction between the center light and the next light on the driver side.

**4.** Thread the support bumper pad supplied with the KC Light bar into the 3/8-16 coupler. Adjust to the height previously measured.

**5.** Remove the light bar from the brackets and set on the ground.

**6.** Remove the flathead bolt connecting the center light to the driver side 3 lights. Hold the support bumper and coupler in place and install the supplied 3/8-16 x 2.50 bolt as shown. Thread the bolt into the coupler. Be sure to keep the coupler stationary using a 3/4 and tighten the bolt to 20 ft-lbs using a 9/16 and a 3/4. [FIGURE 3]

FIG.3



**7.** Mount the light bar to the brackets and tighten until snug. Tilt the bar up to tighten the M10 screws PN: 605839 connecting the brackets to the bumper. Tilt the light bar down until aimed properly. The support bumper pad should be contacting the top of the bumper. Tighten the light bar to the brackets using a 13mm. [FIGURE 4 & 5]

FIG.4

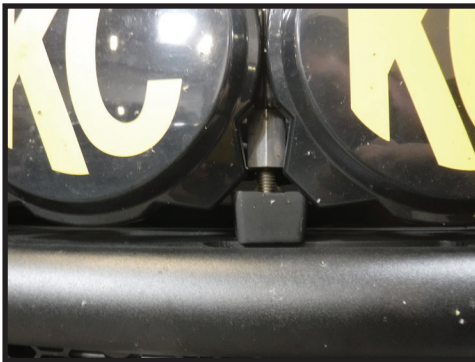

FIG.5



**VERIFY ALL FASTENERS ARE PROPERLY TORQUED BEFORE DRIVING VEHICLE.**

**RETORQUE ALL NUTS, BOLTS AND LUGS AFTER 100 MILES AND PERIODICALLY THEREAFTER.**

### **ICON VEHICLE DYNAMICS LIMITED LIFETIME WARRANTY**

ICON Vehicle Dynamics warrants to the original retail purchaser who owns the vehicle on which the product was originally installed. ICON Vehicle Dynamics does not warrant the product for finish, alterations, modifications and/or installation contrary to ICON Vehicle Dynamics instructions. ICON Vehicle Dynamics products are not designed, nor are they intended to be installed on vehicles used in race applications, for racing purposes or for similar activities. (A "race" is defined as any contest between two or more vehicles, or a contest of one or more vehicles against the clock, whether or not such contest is for a prize). This warranty does not include coverage for police or taxi vehicles, race vehicles, or vehicles used for government or commercial purposes. Also excluded from this warranty are sales outside of the United States of America and Canada.

ICON Vehicle Dynamics' obligation under this warranty is limited to the repair or replacement, at ICON Vehicle Dynamics' discretion, of the defective product. Any and all costs of removal, installation or re-installation, freight charges and incidental or consequential damages are expressly excluded from this warranty. Items that are subject to wear are not considered defective when worn and are not covered.

ICON Vehicle Dynamics components must be installed as a complete kit as shown in our current application guide. Any substitutions or exemptions of required components will immediately void the warranty. Some finish damage may happen to parts during shipping and is not covered under warranty.

This warranty is expressly in lieu of all other warranties expressed or implied. This warranty shall not apply to any product that has been improperly installed, modified or customized subject to accident, negligence, abuse or misuse.